

EXIT 337 - CTY KR, COUNTY LINE RD

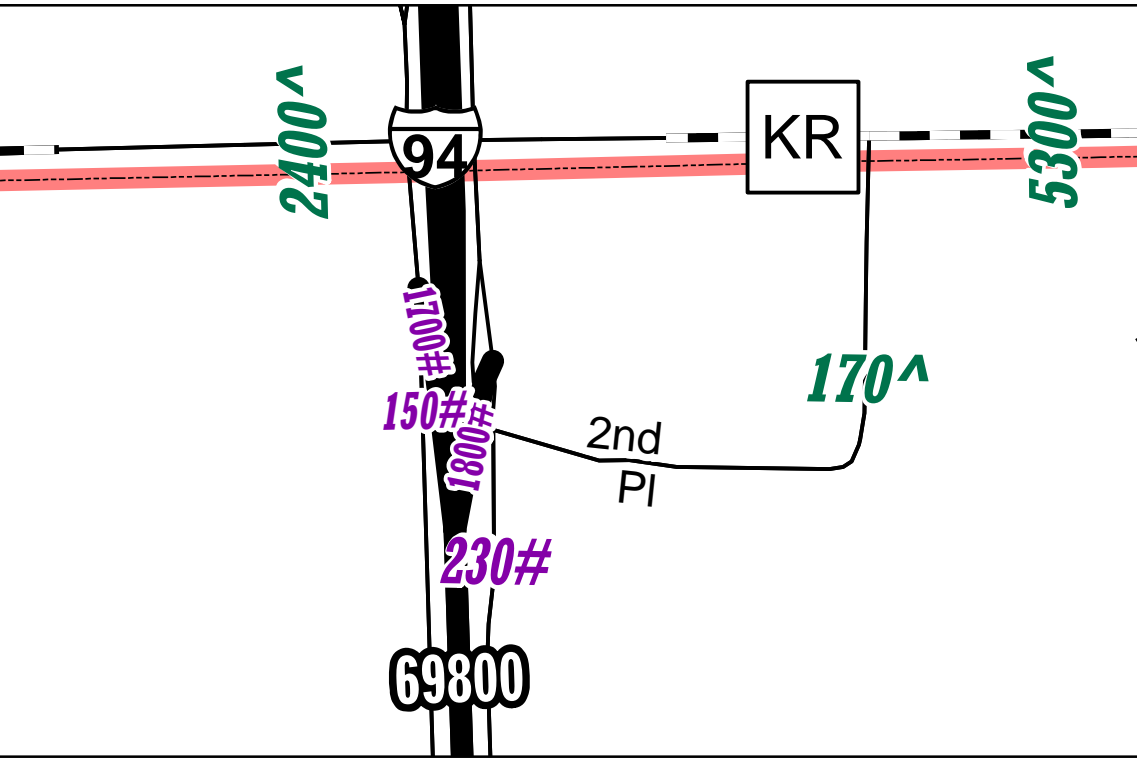

EXIT 339 - CTY E, EAST-WEST

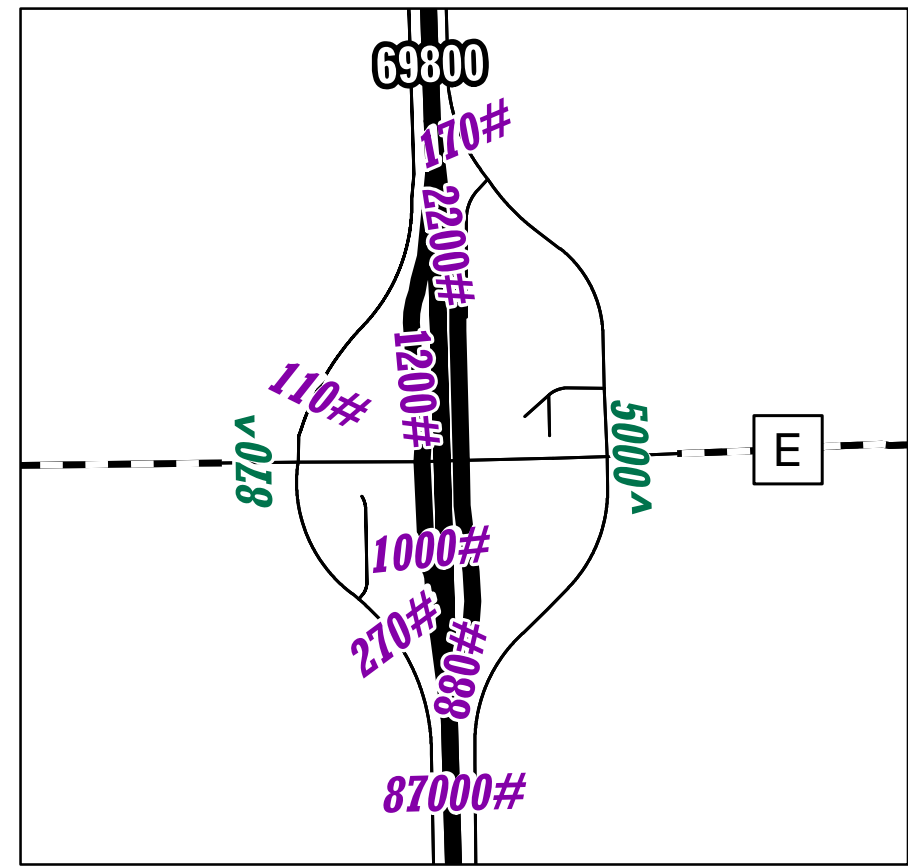

EXIT 342 - HWY 158, KENOSHA

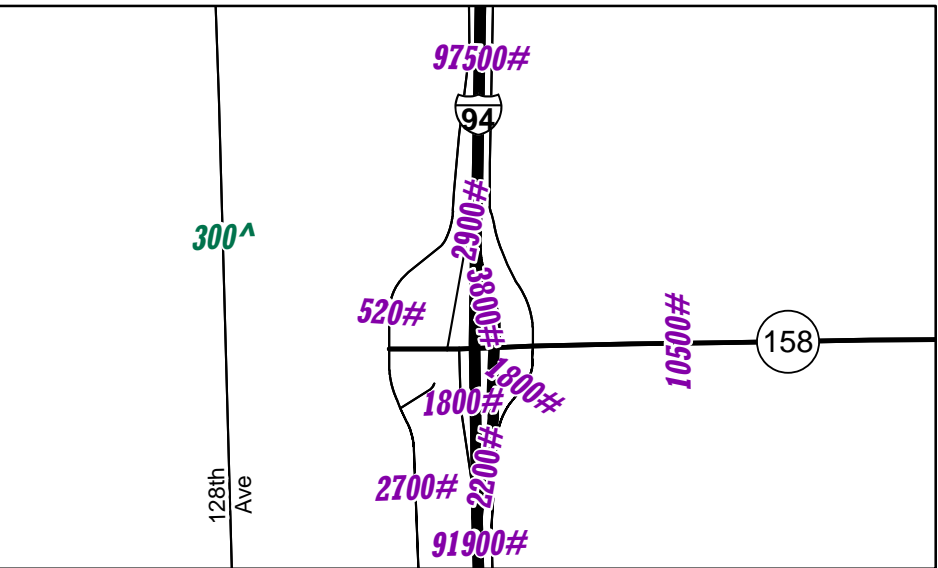

EXIT 345 - CTY C, EAST-WEST

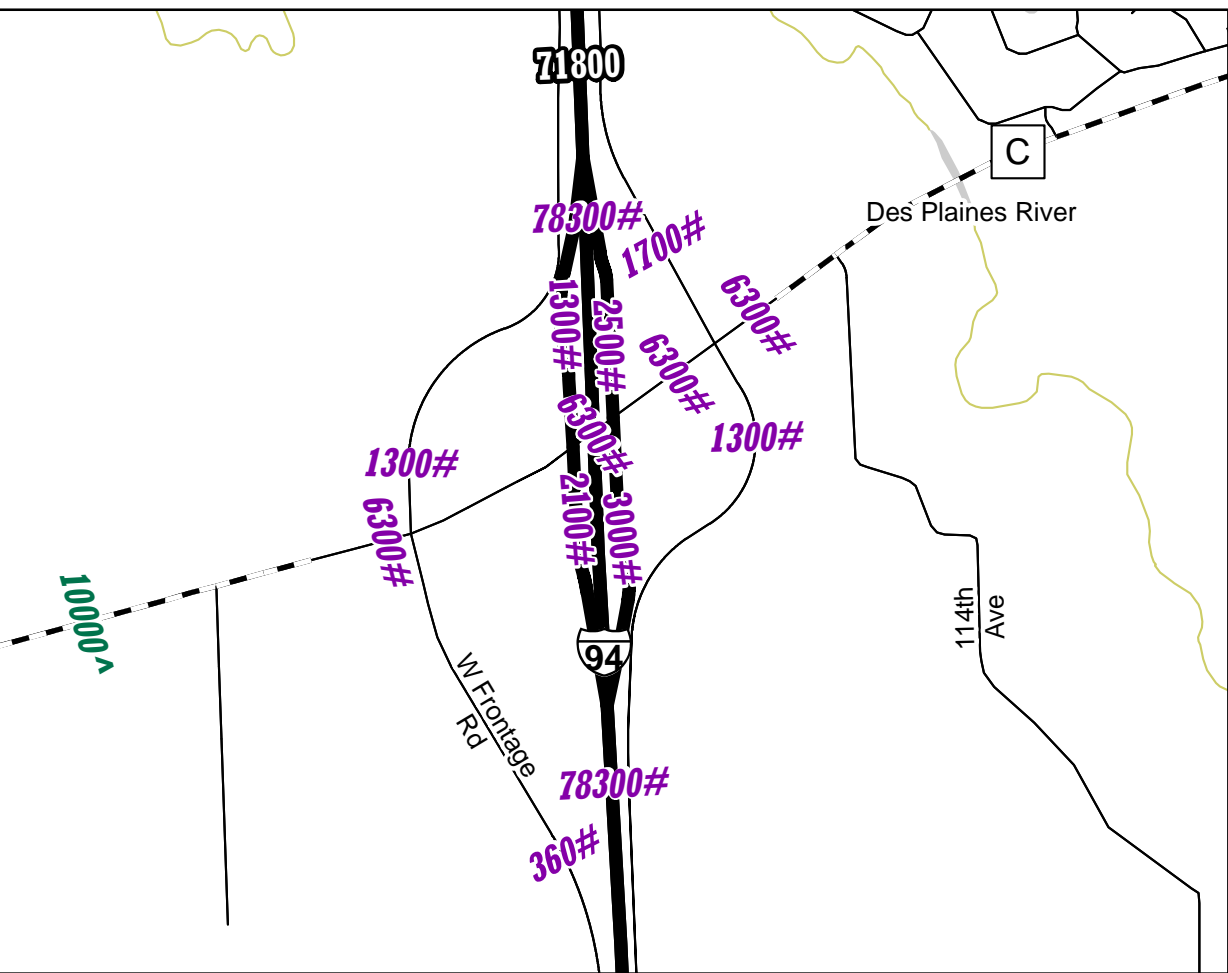

EXIT 340 - HWY 142, CTY S, KENOSHA, BURLINGTON

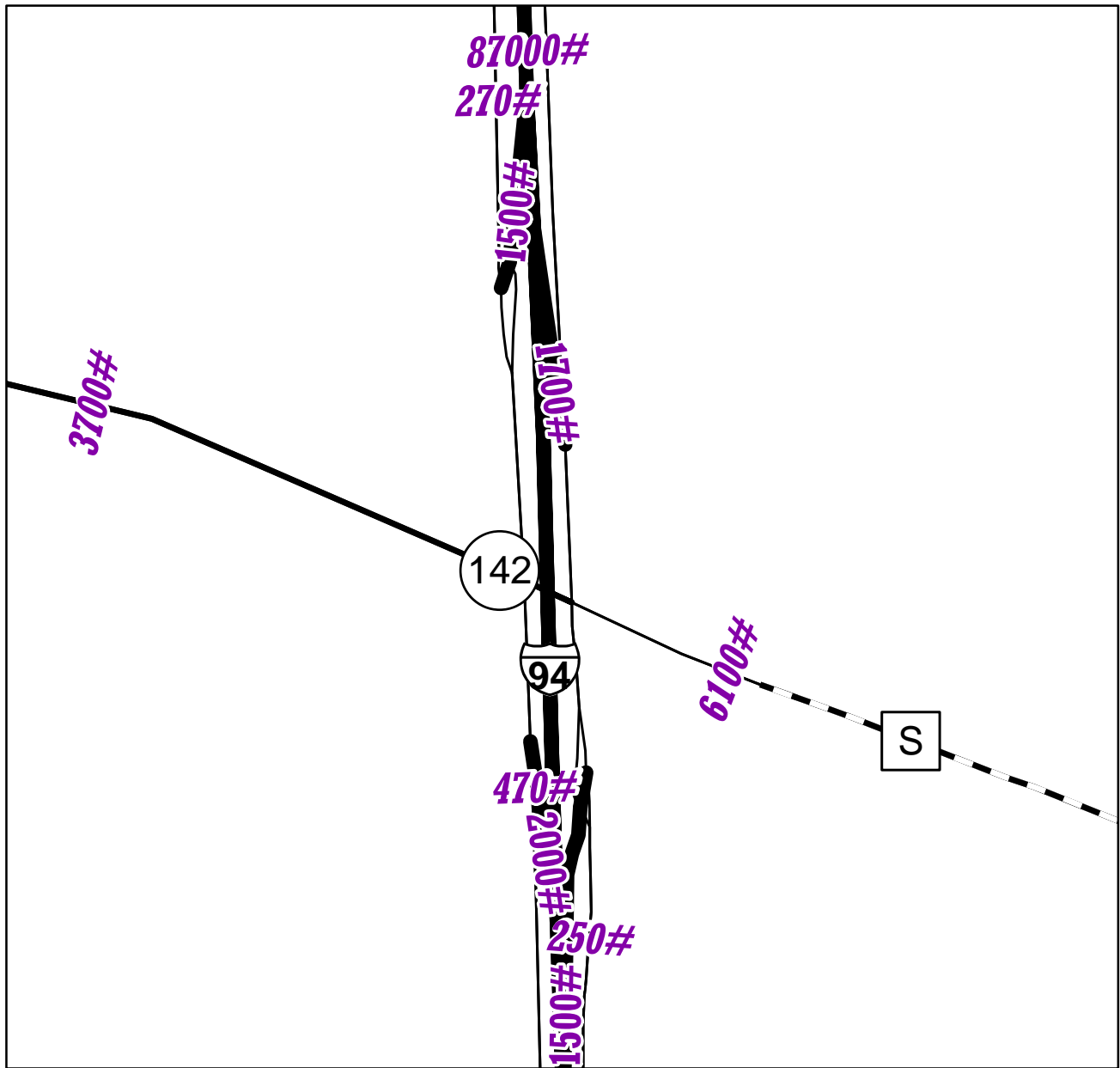

EXIT 344 - HWY 50, KENOSHA, LAKE GENEVA

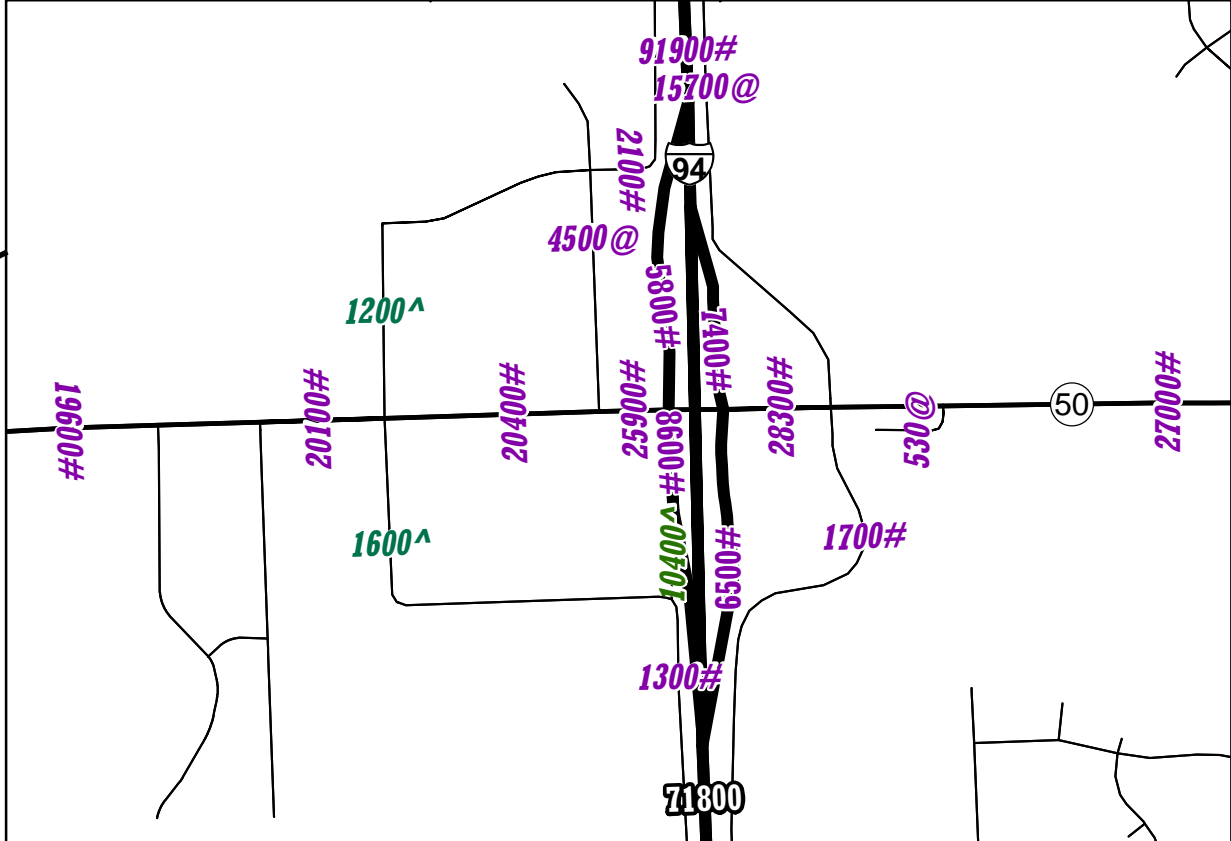

EXIT 347 - HWY 165, CTY Q, LAKEVIEW PKWY

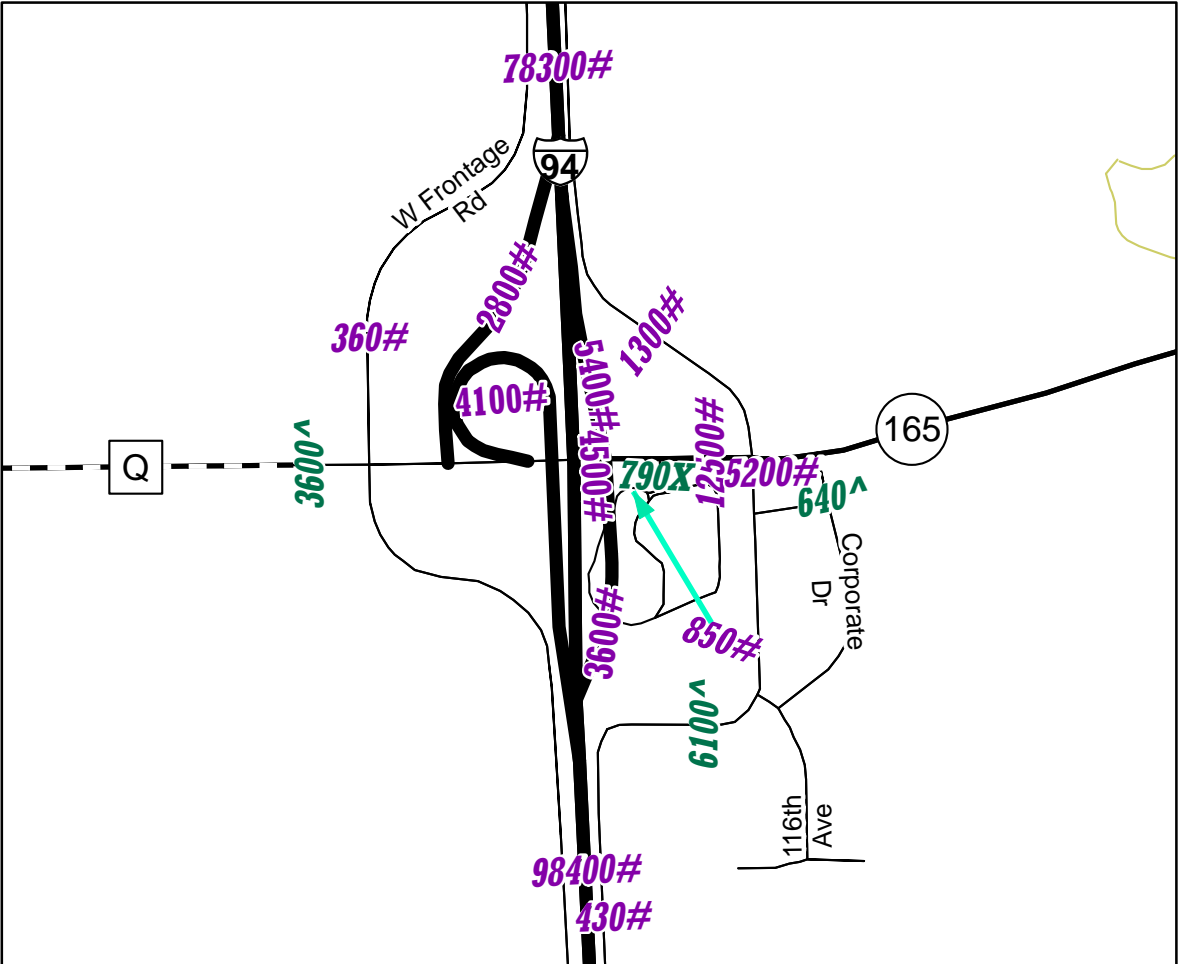

9999 = 2009

2009
INTERSTATE
KENOSHA County

9999# = 2008
9999* = 2007
9999@ = 2006

9999^ = 2005
9999~ = 2004
9999x = 2003 or older

- Character following count value designates the year the count was taken
- Ramp counts lie parallel to road
- AADT for Roads lie perpendicular to road

Legend

- IH
- USH
- STH
- CTH
- Local Roads
- Railroads